



Part NO.	PF083A
	

Rate load	Current	10A	
	Voltage	300V	
Dielectrics withstand voltage		2500V/S	
Ambient temperature		-40℃ ~75℃	
Material		Flame Retardant -PA66+GF (V1/V0)	
Material of clip clutch		QSn6.5-0.1	
Installation		Standard Guide, SCREW	
Accessories		/	
Module		NO	
Packing	Inner packing	Paper box	10PCS
	Outer packing	carton	400PCS
	Carton size		325*230*380mm
	Weight	IPC	Approximate 37g
ICTN		G. W:16G N. W:15KG	

Outside drawing

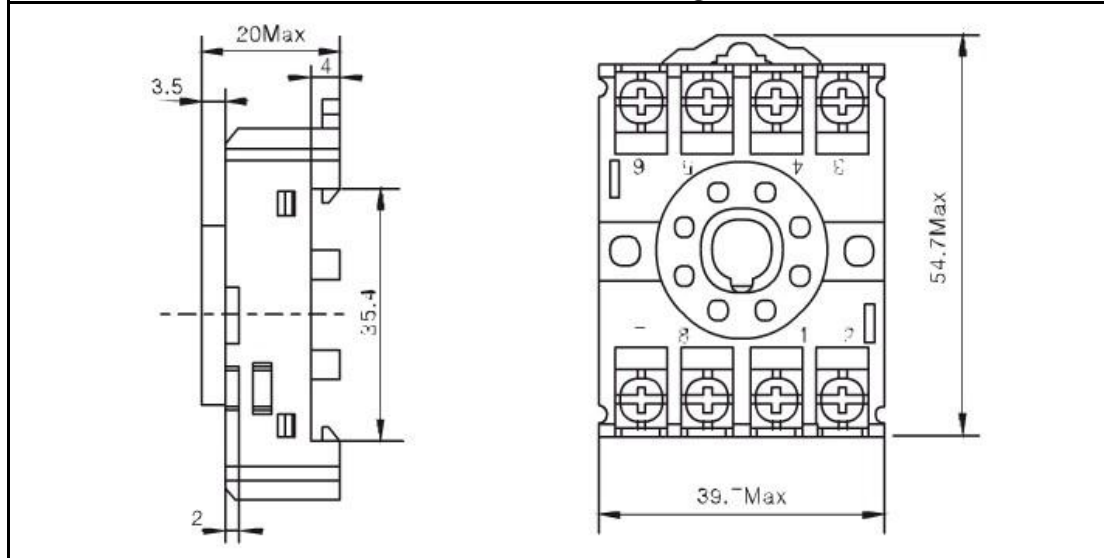

Circuit diagram

